

FLOOR AREA :	
LIVING '1'	- 53.49 m ²
LIVING '2'	- 66.99 m ²
VERANDAH	- 47.06 m ²
FOYER	- 17.30 m ²
ENTRY	- 2.52 m ²
TOTAL	- 187.36 m ²

S 240 V SMOKE DETECTOR FIXED TO CEILING IN ACCORDANCE WITH BCA PART 3.7.2.3 SMOKE ALARM TO COMPLY WITH AS 3786

PROVIDE TEMPERATURE CONTROL DEVICE TO HOT WATER UNIT IN ACCORDANCE WITH A.S. 3500.4.2 1997

CEILING FANS ARE TO BE INSTALLED TO ALL BEDrms. & LOUNGE/DINING AREAS, ASSISTING IN COMPLIANCE WITH Min. 6 STAR ENERGY RATING.

ENSURE ALL WET AREA FLOORS ARE SEALED & FALL TO FLOOR WASTES IN ACCORDANCE WITH B.C.A. 3.8.1.

HOT WATER SYSTEM TO OWNERS SPECIFICATION INSTALLED TO MANUFACTURER'S SPEC.

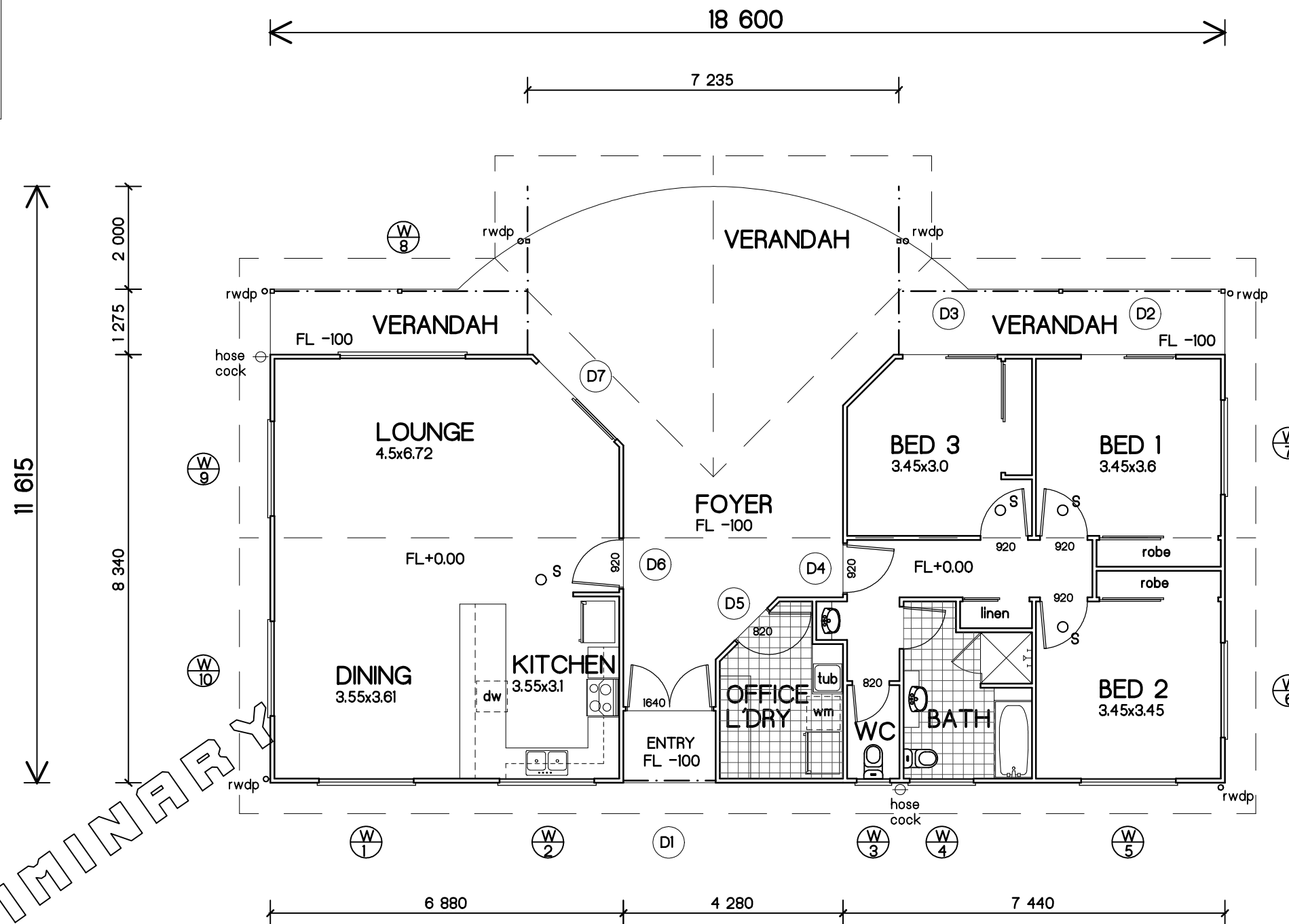

WINDOW SCHEDULE

- W1 1200x1800 SLIDING GLASS WINDOW
- W2 900x1800 SLIDING GLASS WINDOW
- W3 600x600 SLIDING GLASS WINDOW
- W4 600x1200 SLIDING GLASS WINDOW
- W5 1200x1800 SLIDING GLASS WINDOW
- W6 900x1800 SLIDING GLASS WINDOW
- W7 900x1800 SLIDING GLASS WINDOW
- W8 1800x2400 SLIDING GLASS WINDOW
- W9 1200x1800 SLIDING GLASS WINDOW
- W10 1200x1800 SLIDING GLASS WINDOW

- D1 DOUBLE 2040x820 SOLID CORE ENTRY DOOR
- D2 2100x1800 SLIDING GLASS DOOR
- D3 2100x1800 SLIDING GLASS DOOR
- D4 2040x920 SOLID CORE ENTRY DOOR
- D5 2040x820 SOLID CORE LAUNDRY DOOR
- D6 2040x920 SOLID CORE ENTRY DOOR
- D7 2100x2100 SLIDING GLASS DOOR

PRELIMINARY

FLOOR PLAN

Homefab
Strong-smart-fast. Built to last.
6 Slade Street - PO Box 665 Mareeba,
Queensland 4880 Australia.
ABN: 21 603 460 395. Phone: 07 4092 2369
Fax: 07 4092 2355.
Website: www.homefab.com.au.
Email: sales@homefab.com.au

pd designs
building designers

P 07 4056 1883.
F 07 4056 3595
M 0427 561 883
E info@pddesigns.com.au
96A gordon street, gordonvale,
QLD. 4865
lic. under QBCC Act 1991 - No. 1191543
obn: 73 437 147 573
acn: 143 382 699



Use figured dimensions in preference to scale. Check all dimensions on site before fabrication or building work.

© These drawings and designs are Copyright

1:100 ON A3 SHEET

'KAIRI'
3 BEDROOM RESIDENCE
for :
HOMEFAB

NOVEMBER 2017

2302

WIND CLASSIFICATION

W1

OF ?

C2